

**American
Red Cross**

South Plains Regional Chapter

CHAIRMAN OF THE BOARD

Greg Bruce
Division Director
UMC Health System

GOVERNANCE MEMBERS

Andy Anderson
Retired
National Weather Service

Jan Barnett
Managing Director
Life Gift

Lynda Billings
Special Projects Director
TTUHSC School of Nursing

Gantt Bumstead
President
United Supermarkets

Rex Castle
Senior Vice President Human Resources
State National Bank

Chris Coke
1st National Bank Texas

Bob Curlee
Retired
Texas Instruments

Mike Fox
Business Development Officer
Wells Fargo Bank – Plainview

Ysidro Gutierrez
Lubbock County Commissioner

Judy Helm
Vice President
First Bank & Trust

Royce Ivory
Brig. General, Retired
Army National Guard

Brad Jensen
Managing Partner
New York Life

Greg Jones
Executive Vice President
American State Bank

Annette Kluck
Graduate Student in Psychology
Texas Tech University

Ben Morgan
Graduate Student/Physical Therapist
Texas Tech University/University Medical Center

Dr. Ruth Morrow
Retired
Texas Tech University

Eddie Owens
Director of Communications
United Supermarkets

Beverly Riley
Human Resources Manager
X-FAB Texas, Inc.

Rick Woody
Assistant Principal
Lubbock High School

MANAGEMENT STAFF

Janie Arellano
AFES/Health & Safety Director

Jimmy Castillo
Director of Development

Tim Hill
Director of Disaster Services

Sam Hollingsworth
Accountant

Tammy Coleman
SSDA / Program Coordinator

Rhonda DiSalvo
SSDA / Health and Safety Instructor



Together, we can save a life

February 2005

This year, as in years past, our Chapter impacted many South Plains area residents by helping to save lives and bringing relief to individuals and families throughout communities. Faced with an increasing awareness of the threat of large-scale disasters, the South Plains Regional Chapter also impacted the entire country by leading the way in developing readiness programs and participating in simulation events to test our ability to respond to emergencies.

Today, as always, our Chapter will provide relief to families impacted by a residential fire and train hundreds in life-saving and disaster preparedness skills. Because of the volunteers utilized by our Chapter, dedicated staff, and your generous support we were again able to keep our commitment to support the many people we serve - **thank you**. As the number of disasters increase in the area, the country, and the world, our reach continues to expand and the South Plains Regional Chapter continues to find new and better ways to carry out our mission. Together, we have prepared the South Plains to be an even safer community.

As we uphold our mission to prevent, prepare for and respond to the future challenges we will face, we will all watch with pride as the rest of the country follows suit.

A handwritten signature in black ink, appearing to read "Greg Bruce".

Greg Bruce
Chairman of the Board

2003-2004

TOGETHER WE PREPARE:

This year, your local Red Cross was able to directly impact individuals in the South Plains because of the generous support of various corporate sponsors, private grants, and the contributions of kind individuals throughout the community. Once again, we say Thank You. Together, we can save a life.

131

Families were helped by LOCAL DISASTER RELIEF efforts this year. Because of your time and financial support the victims of these local disasters received food, clothing, and shelter in their time of greatest need.

561

Local individual residents were helped by LOCAL DISASTER RELIEF efforts this year.

2

Multi-Families residents were helped by LOCAL DISASTER RELIEF efforts this year.

617

Military families were served by ARMED FORCES EMERGENCY SERVICES during the War in Iraq. For years we have connected military families and loved ones in emergencies, and we continued our commitment this year to support our soldiers at home and overseas.

\$5,338

Financial assistance loans were provided to families of military personnel through the Military Aid Relief Society.

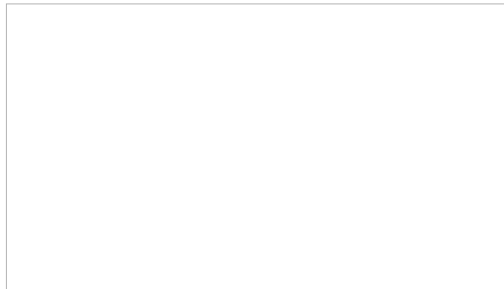
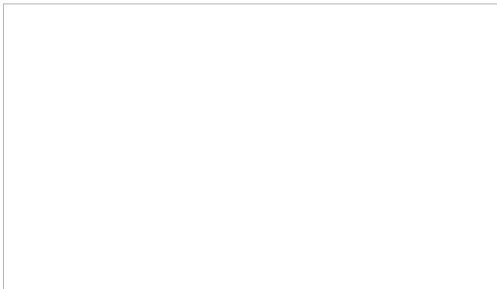
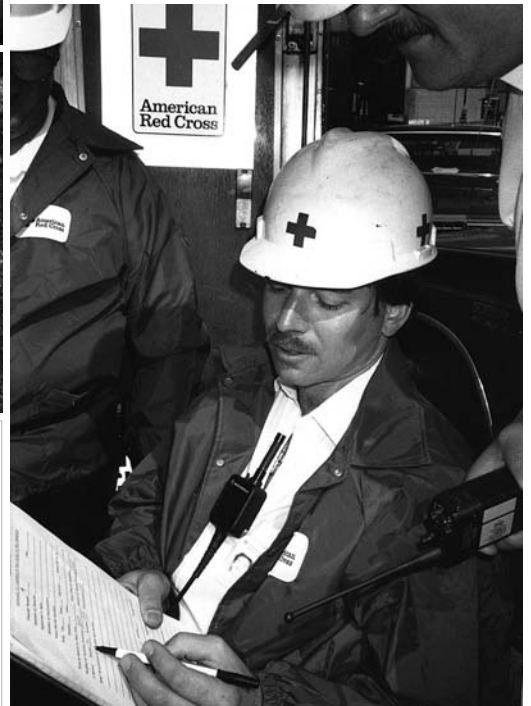
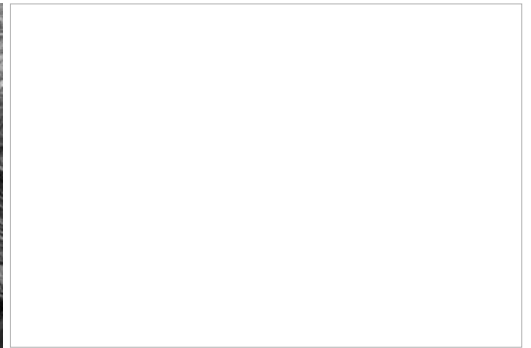

5,212

The South Plains residents and youth were trained in lifesaving skills such as FIRST AID, CPR, AQUATICS, and COMMUNITY DISASTER EDUCATION by volunteers and staff members throughout the area.

100

residents received free CPR training during Red Cross Month's first annual CPR SATURDAYS. Classes took place at the Texas Tech University's United Spirit Arena.

25

First aid stations are provided to local events such as parades, conventions, and sporting events. First aid stations are staffed with competent personnel who know how to respond to victims of injury or sudden illness before the arrival of EMS personnel. First aid stations are designed to provide competent, immediate, and temporary care for injuries and sudden illnesses.

8

Mass Care operations were provided to local disasters.

Actions to the new TOGETHER WE PREPARE campaign come together to save lives, support programs, and prevent disasters. By building a kit, making a plan, getting trained, volunteering, we will all possess the skills necessary to make South Plains a safer community.

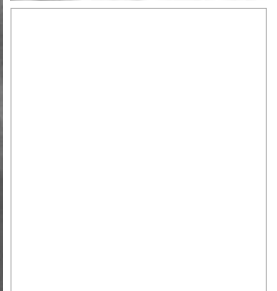
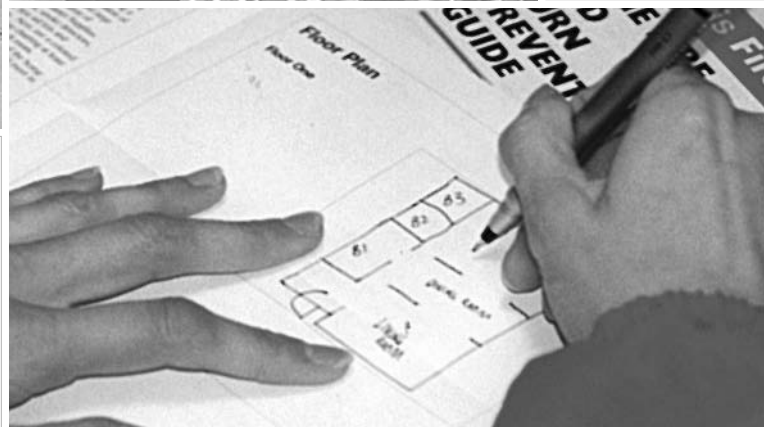
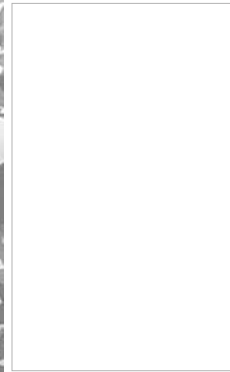

**South Plains Regional Chapter American Red Cross
Summary Financial Information**

Statement of Financial Position June 30, 2004	Statement of Activities For this Year Ended June 30, 2004
ASSETS Cash \$ 36,888 Investments 29,297 Accounts 156,823 Resale Inventory 14,600 Land, Building & Equipment Net of Accumulated Depreciation <u>241,923</u> Total Assets \$ <u>479,531</u>	REVENUE Current Fund Campaign \$ 277,995 Products and Services 84,075 Contributions 300,780 Disaster Relief 1,000 Non-Federal Grants 4,958 Fund raising Events 14,487 Sale of Materials 54,875 Rental Revenue 4,434 Other Income 12846 Interest Income <u>1,108</u> Total Revenue \$ <u>758,558</u>
LIABILITIES Accounts Payable – General \$ 14,218 Lease Payable <u>13,888</u> Total Liabilities \$ <u>28,106</u>	EXPENSES – PROGRAM SERVICES Armed Forces Emergencies Services \$ 74,509 Disaster Services 160,226 Health Services 168,525 Management & General <u>150,346</u> Total Expenses \$ <u>553,606</u>
NET ASSETS Unrestricted 313,263 Temporarily Restricted <u>138,162</u> Total Net Assets \$ <u>451,425</u>	Change in Net Assets \$ 202,952 Net Assets – Beginning of the Year <u>248,473</u> Net Assets – End of Year \$ <u>451,425</u>
Total Liabilities and Net Assets \$ <u>479,531</u>	

BOLINGER, SEGARS, GILBERT & MOSS, L.L.P.
 CERTIFIED PUBLIC ACCOUNTANTS
 1623 10TH STREET
 LUBBOCK, TEXAS 79401-2685

To the Members
 South Plains Regional Chapter American Red Cross
 Lubbock, Texas

We have audited, in accordance with generally accepted auditing standards, the statement of financial position of the South Plains Regional Chapter of the American Red Cross as of June 30, 2004, and the related statements of activities, cash flows, and functional expenses for the year then ended (not presented herein); and in our report dates August 19, 2004, we expressed an unqualified opinion on those financial statements.

In our opinion, the information set forth in the accompanying condensed financial statements is fairly stated in all material respects in relation to the to the financial statements from which it was derived.

Certified Public Accountants

Lubbock, Texas
 August 19, 2004

A Task Worthy of Your Support Planned Giving To The American Red Cross

At Some time, The Red Cross has touched your life. Perhaps, we helped you when you were in the military service. Perhaps, it was during a disaster, like a tornado or fire. Maybe, you have had Red Cross First Aid or CPR training. Quite possibly, you had Red Cross swimming classes when you were young, or your children have benefited from the classes.

You know what the Red Cross does. You know how the Red Cross helps. You can also help make sure that the South Plains Regional Chapter of the American Red Cross can continue its task in the years to come. Our Planned Giving & Endowment Fund Program is designed to benefit not only the Red Cross, but also you, the donor. Changes in the tax laws in 1981 and 1986 enhance the benefits to donors who use planned giving programs. A planned gift – through you will, trust, charitable annuity, life insurance, retirement plans, securities, real estate, antiques or jewelry – will also provide you greater current and/or future tax benefits.

There are many good reasons for you to find out about the Planned Giving & Endowment Fund Program. You may wish to honor a loved one or a special occasion for estate or income tax benefits, because you believe in the Red Cross and take joy from giving. We would encourage you to follow through on these motives. Should you wish to explore the benefits of the Planned Giving & Endowment Fund Program, please give us a call at the Red Cross office. We think the task of the Red Cross is honestly worthy of your support.

How to include the American Red Cross in your will . . .

Many of our supporters make charitable gifts by naming the South Plains Regional Chapter American Red Cross as a beneficiary in their wills. The federal government encourages these gifts or bequests, by allowing an unlimited estate tax charitable deduction.

To make a bequest to the Red Cross, the following language will be helpful to your lawyer:

I give, devise, and bequeath to the American Red Cross for the benefit of the South Plains Regional Chapter the sum of _____ (or otherwise describe the gift or specify a percentage of the estate).



There are three ways you can make a bequest:

Specific Bequest You designate a specific dollar amount, specific percentage, or specific property to the South Plains Regional Chapter American Red Cross.

Residual Bequest Your estate will pay all debts, taxes, expenses, and specific bequests. The remaining amount--the residue--will be transferred to the South Plains Regional Chapter American Red Cross.

Contingent Bequest You can ask that the South Plains Regional Chapter American Red Cross receive all or a portion of your estate only under certain circumstances. For example, you can name the Red Cross as a beneficiary of your estate only if there are no surviving close family members. Childless couples sometimes provide for the entire estate to go to the surviving spouse, or if the spouse does not survive, to the Red Cross.

When you are a planned gift donor, the Red Cross will honor you with membership in the Legacy Society. If you have already made a plan to give to the Red Cross in your will or estate plan, please contact us at **(806) 765-8534**. We realize that with your special gift, you consider us to be part of your family, and we want to do our best to keep you informed as to how your gift will be used and to give you the opportunity to tell us of your wishes.

